

28	CWC-SE0018-P04_PLATE SECURING PIN	1
27	BN616-1076469 M3X8 SCREW HEX COUNTERSUNK	4
26	CWC-SE0017-P04_CABLE RELAXER	2
25	CONNECTOR MOLEX MICROFIT 2X2 SOCKET 430200400	4
24	METAL BELLOWS COUPLING MAEDER MBK 60151806	1
23	CWC-SE0014-P04_TORQUE SENSOR TD50 ASSEMBLY	1
22	CWC-SE0011-P04_TORQUE SENSOR TUB TD50	1
21	CWC-SE0012-P04_TORQUE SENSOR HOLDER TD50	1
20	CWC-SE0013-P04_TORQUE SENSOR AXLE TD50	1
19	TORQUE SENSOR TRANSMETRA TD50	1
18	CWC-SE0010-P04_TORQUE SENSOR TD70 ASSEMBLY	1
17	CWC-SE0007-P04_TORQUE SENSOR TUB TD70	1
16	CWC-SE0008-P04_TORQUE SENSOR HOLDER TD70	1
15	CWC-SE0009-P04_TORQUE SENSOR AXLE TD70	1
14	TORQUE SENSOR TRANSMETRA TD70	1
13	BN616-1235206 M4X12 SCREW HEX COUNTERSUNK	8
12	CWC-PR0004-P04_PCB HOLDER	3
11	CWC-PR0011-A04_MOTOR BUS PCB ASSEMBLY	3
10	BN610-1421506 M2.5X5 HEX SOCKET SCREW	12
9	CWC-SE0006-P04_SENSING CYLINDER	3
8	MOTOR MYACTUATOR L-4010	3
7	CWC-SE0004-P04_BEARING HOLDER FWD	2
6	BALL BEARING SKF 626-2RSH	2
5	CWC-SE0003-P04_SENSING ADAPTER PLATE	1
4	CWC-SE0002-P04_SENSING FRAME	1
3	CWC-SE0001-P04_SENSING BASEPLATE	1
2	BN610-1233114 M3X8 SCREW HEX SOCKET	40
1	BN715-1777491 FLAT WASHER M3	36
PC NO	PART NAME	QTY

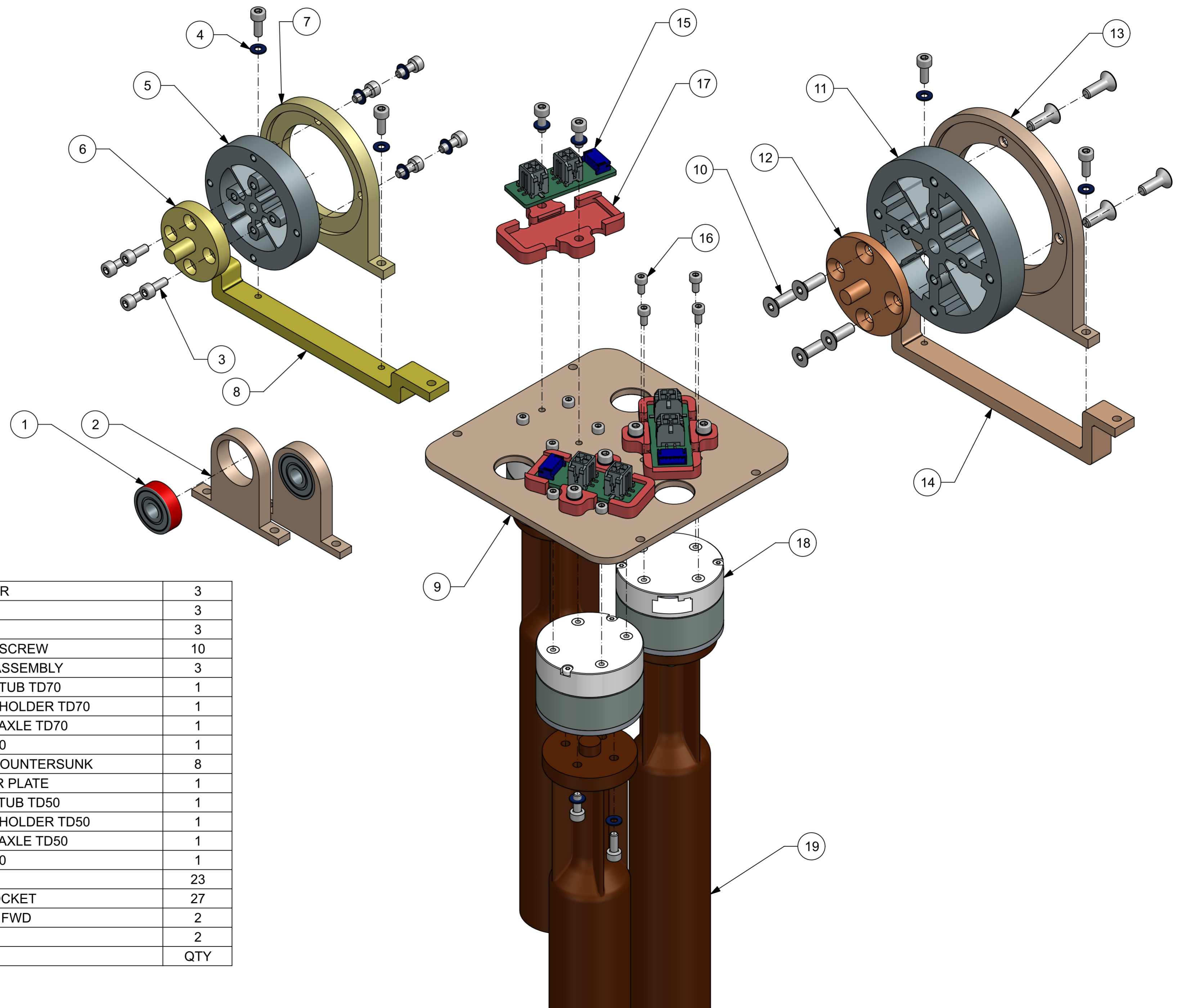

Not both torque sensors are necessary - use the most suitable one

19	CWC-SE0006-P04_SENSING CYLINDER	3
18	MOTOR MYACTUATOR L-4010	3
17	CWC-PR0004-P04_PCB HOLDER	3
16	BN610-1421506 M2.5X5 HEX SOCKET SCREW	10
15	CWC-PR0011-A04_MOTOR BUS PCB ASSEMBLY	3
14	CWC-SE0007-P04_TORQUE SENSOR TUB TD70	1
13	CWC-SE0008-P04_TORQUE SENSOR HOLDER TD70	1
12	CWC-SE0009-P04_TORQUE SENSOR AXLE TD70	1
11	TORQUE SENSOR TRANSMETRA TD70	1
10	BN616-1235206 M4X12 SCREW HEX COUNTERSUNK	8
9	CWC-SE0003-P04_SENSING ADAPTER PLATE	1
8	CWC-SE0011-P04_TORQUE SENSOR TUB TD50	1
7	CWC-SE0012-P04_TORQUE SENSOR HOLDER TD50	1
6	CWC-SE0013-P04_TORQUE SENSOR AXLE TD50	1
5	TORQUE SENSOR TRANSMETRA TD50	1
4	BN715-1777491 FLAT WASHER M3	23
3	BN610-1233114 M3X8 SCREW HEX SOCKET	27
2	CWC-SE0004-P04_BEARING HOLDER FWD	2
1	BALL BEARING SKF 626-2RSH	2
PC NO	PART NAME	QTY

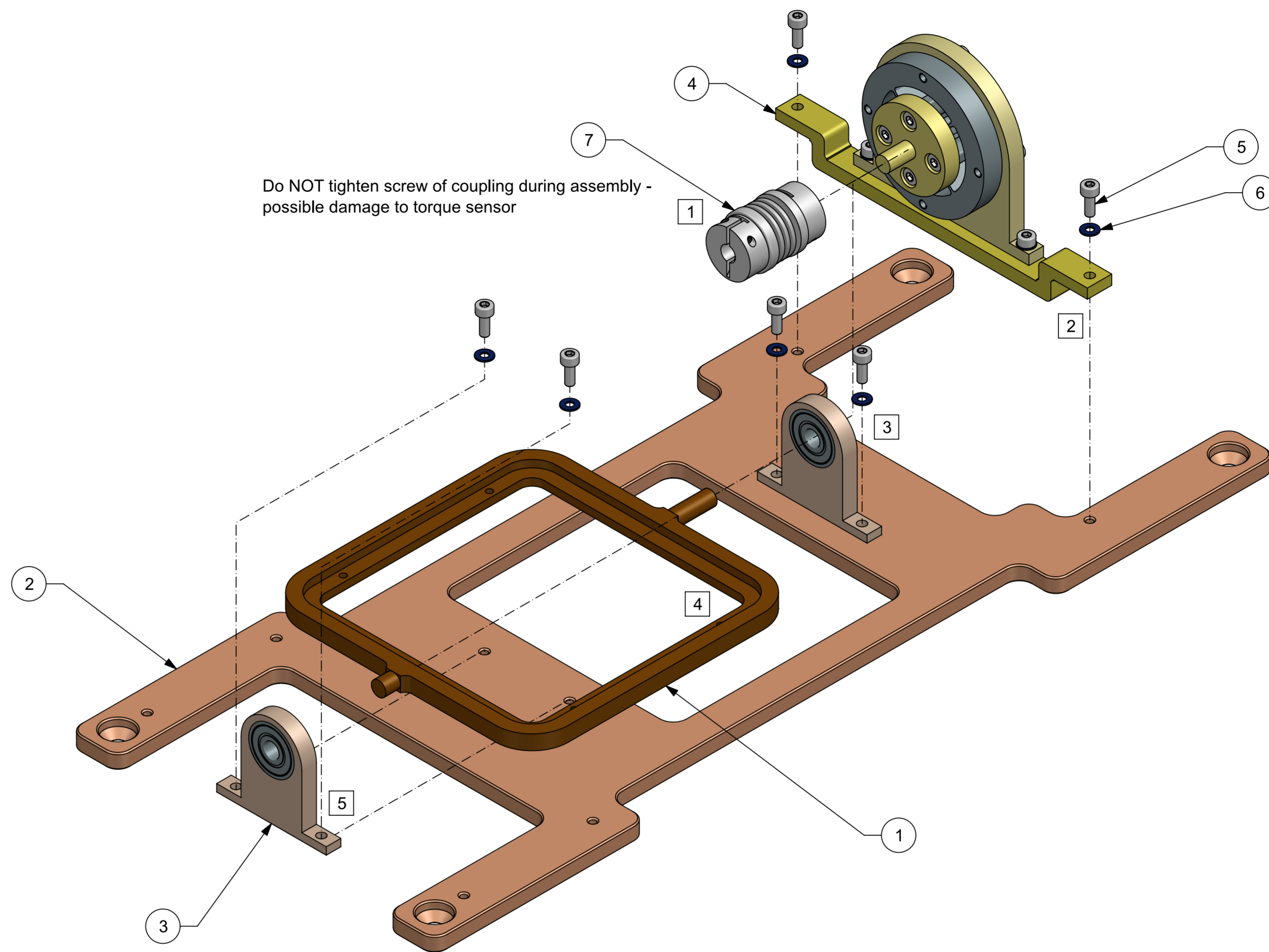

Follow the advised assembly order in the square boxes

7	METAL BELLOWS COUPLING MAEDER MBK 60151806	1
6	BN715-1777491 FLAT WASHER M3	6
5	BN610-1233114 M3X8 SCREW HEX SOCKET	6
4	CWC-SE0014-P04_TORQUE SENSOR TD50 ASSEMBLY	1
3	CWC-SE0004-P04_BEARING HOLDER FWD	2
2	CWC-SE0001-P04_SENSING BASEPLATE	1
1	CWC-SE0002-P04_SENSING FRAME	1
PC NO	PART NAME	QTY

4	CWC-SE0001-P04_SENSING BASEPLATE	1
3	BN715-1777491 FLAT WASHER M3	4
2	BN610-1233114 M3X8 SCREW HEX SOCKET	4
1	CWC-SE0003-P04_SENSING ADAPTER PLATE	1
PC NO	PART NAME	QTY

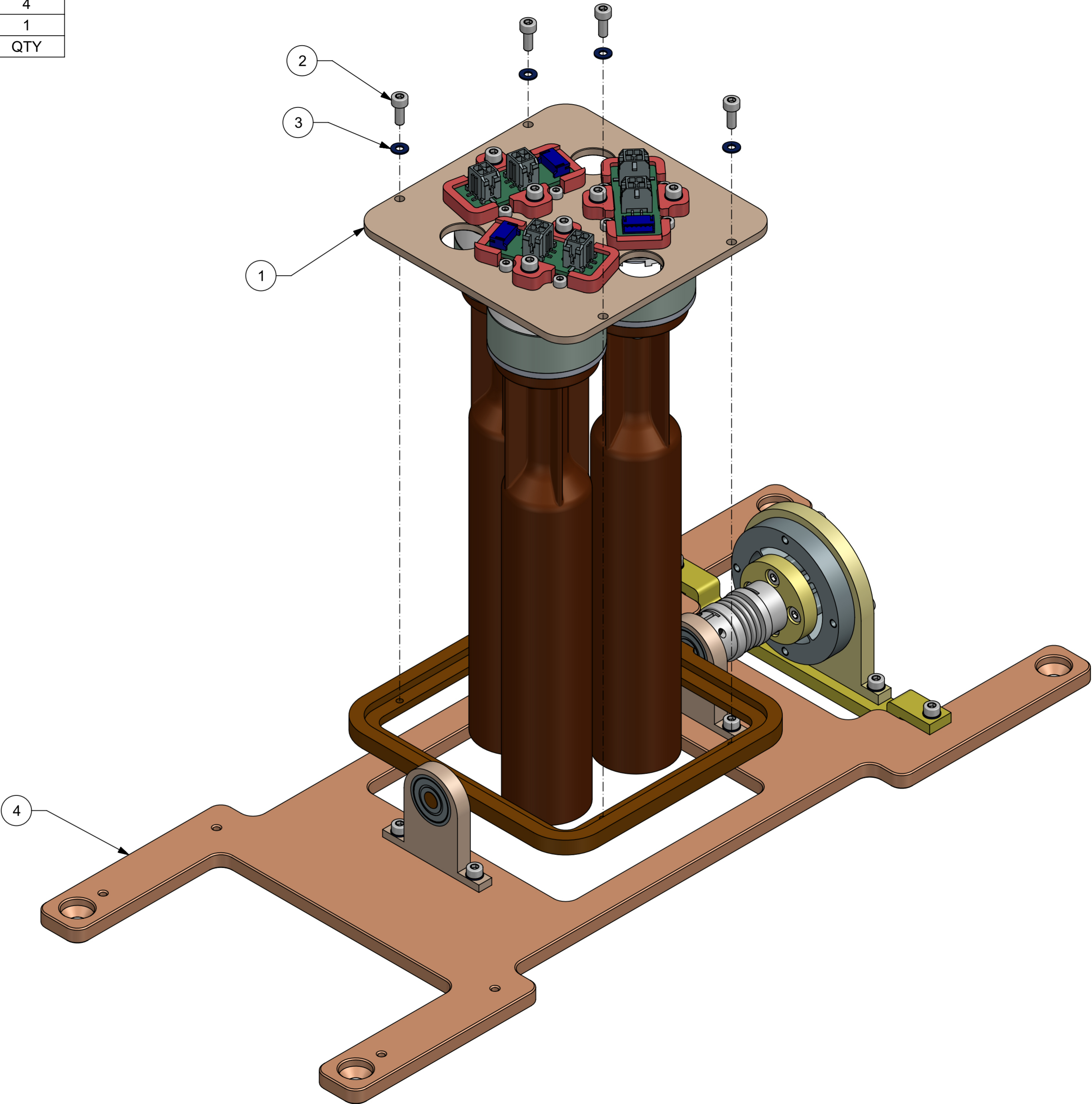

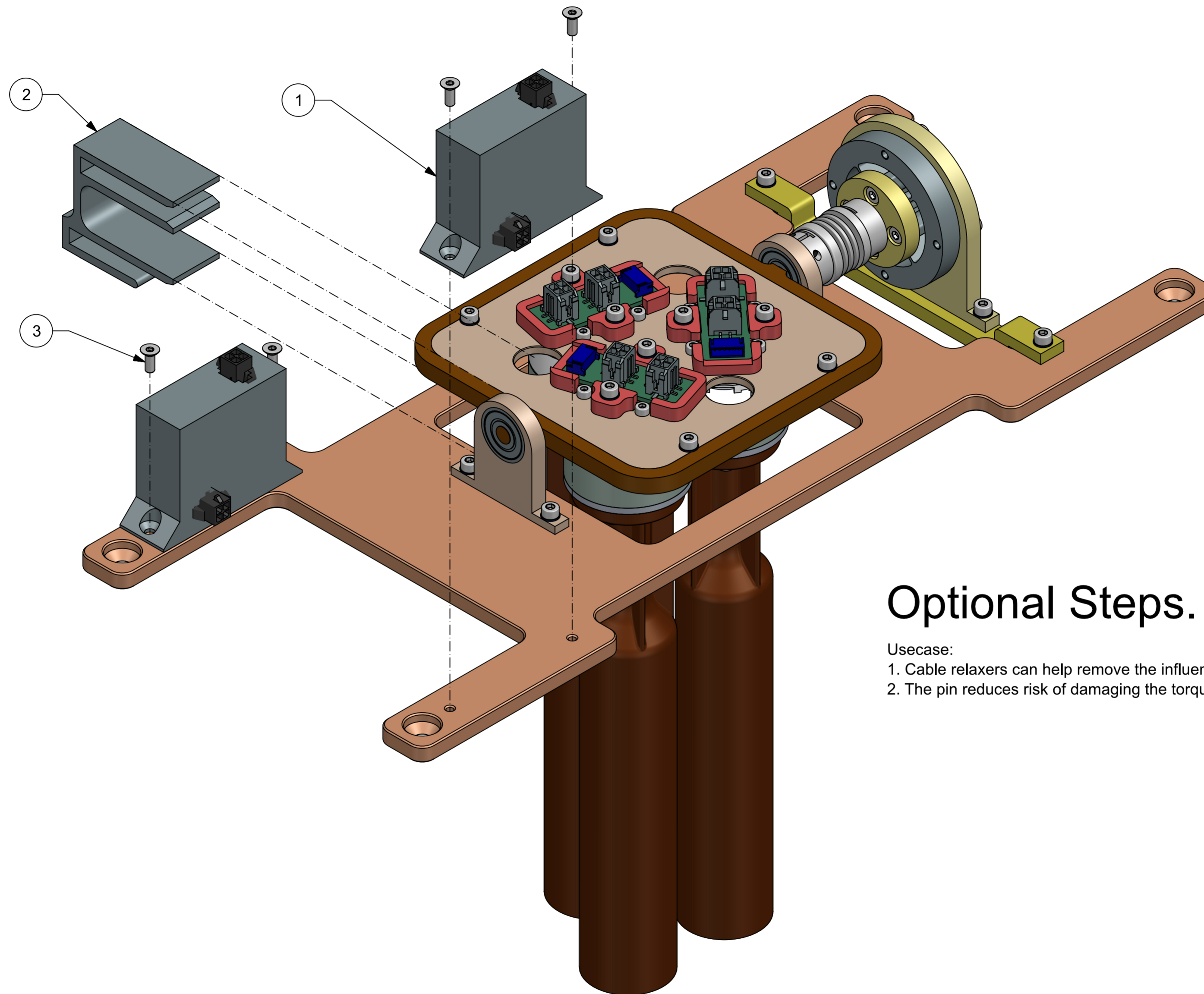

Optional Steps.

Usecase:

1. Cable relaxers can help remove the influence of the motor cables to the measurement
2. The pin reduces risk of damaging the torque sensor when the system is not in use.

3	BN616-1076469 M3X8 SCREW HEX COUNTERSUNK	4
2	CWC-SE0018-P04_PLATE SECURING PIN	1
1	CWC-SE0017-P04_CABLE RELAXER	2
PC NO	PART NAME	QTY