

12	CWC-ST0010-P99_OVERTANK COLUMN ACRYLIC CONNECTOR	1
11	CWC-ST0011-P99_OVERTANK COLUMN ACRYLIC CONNECTOR MIRRORED	1
10	BN37885-3794588 M3 THREADED INSERT	2
9	ABDECKKAPPE PROFIL 5 ITEM 0.0.370.09	2
8	BN610-1111353 M4X14 SCREW HEX SOCKET	6
7	NUTSTEIN M4 PROFIL 5 ITEM 0.0.425.10	6
6	CWC-ST0005-P99_ITEM INSIDE BAR WIDTH	1
5	CWC-ST0004-P99_ITEM INSIDE BAR HEIGHT SHORT	2
4	BN616-1208187 M5X8 SCREW HEX COUNTERSUNK	8
3	WINKEL PROFIL 5 ITEM 0.0.677.77	2
2	NUTSTEIN M5 PROFIL 5 ITEM 0.0.425.11	8
1	APISQUEEN U5 FRESHWATER THRUSTER	3
PC NO	PART NAME	QTY

Necessary Tools:

- Allen keys
- Rubber Mallet
- Soldering iron (for threaded inserts)

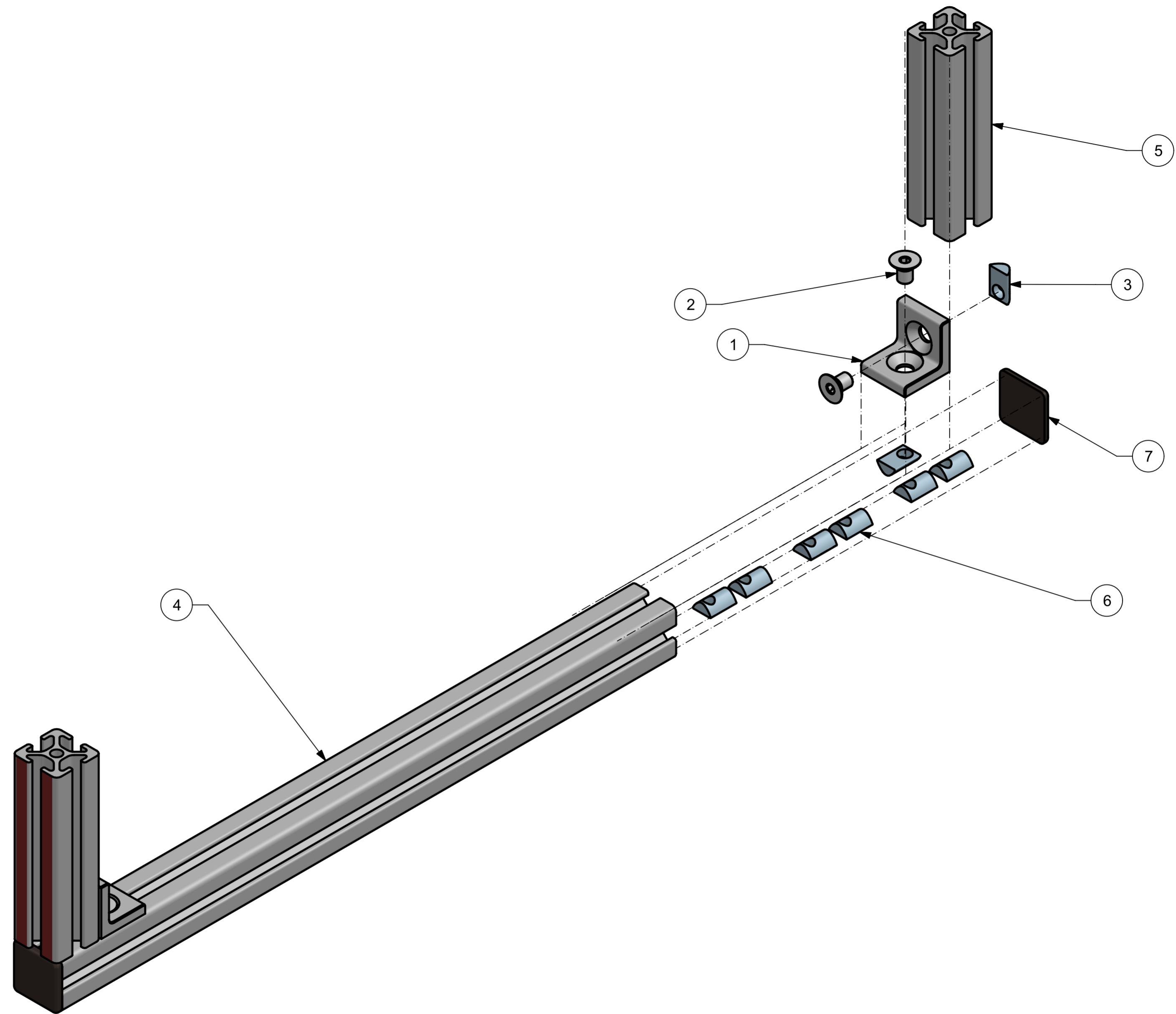

7	ABDECKKAPPE PROFIL 5 ITEM 0.0.370.09	2
6	NUTSTEIN M4 PROFIL 5 ITEM 0.0.425.10	6
5	CWC-ST0004-P99_ITEM INSIDE BAR HEIGHT SHORT	2
4	CWC-ST0005-P99_ITEM INSIDE BAR WIDTH	1
3	NUTSTEIN M5 PROFIL 5 ITEM 0.0.425.11	4
2	BN616-1208187 M5X8 SCREW HEX COUNTERSUNK	4
1	WINKEL PROFIL 5 ITEM 0.0.677.77	2
PC NO	PART NAME	QTY

0. (OPTIONAL) Apply 3mm x 6mm PVC Tape on the red marked area.
1. Connect the item bars as shown.
2. (OPTIONAL) Slide-in the M4 Profile Nuts (6).
3. Attach item cover plates (7).
- 3.a) Rubber mallet might be necessary.
4. Ensure the height bars (5) are flush with the cover plates (7).
- 4.a) Tighten the M5 screws.

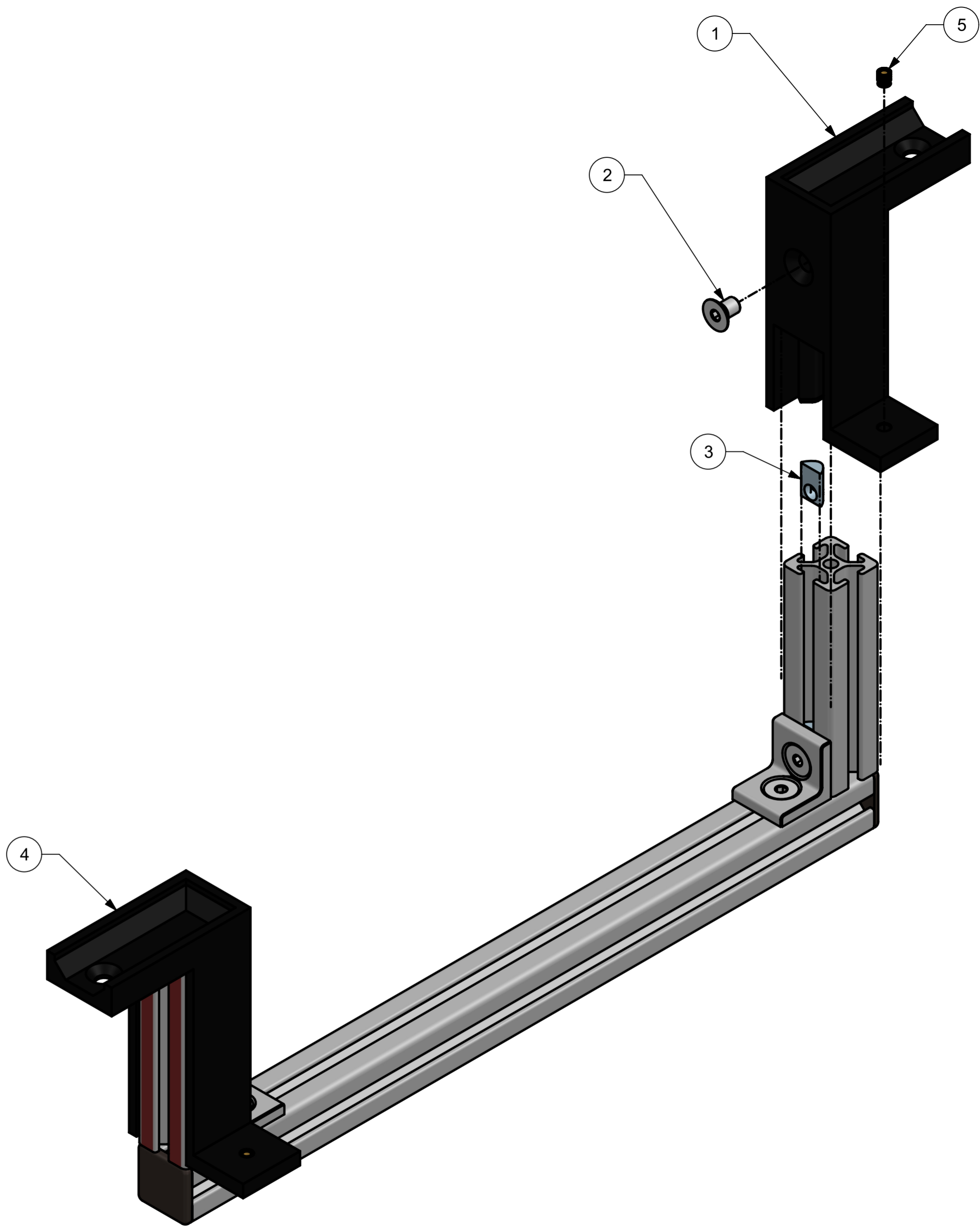

5	BN37885-3794588 M3 THREADED INSERT	2
4	CWC-ST0010-P99_OVERTANK COLUMN ACRYLIC CONNECTOR	1
3	NUTSTEIN M5 PROFIL 5 ITEM 0.0.425.11	4
2	BN616-1208187 M5X8 SCREW HEX COUNTERSUNK	4
1	CWC-ST0011-P99_OVERTANK COLUMN ACRYLIC CONNECTOR MIRRORED	1
PC NO	PART NAME	QTY

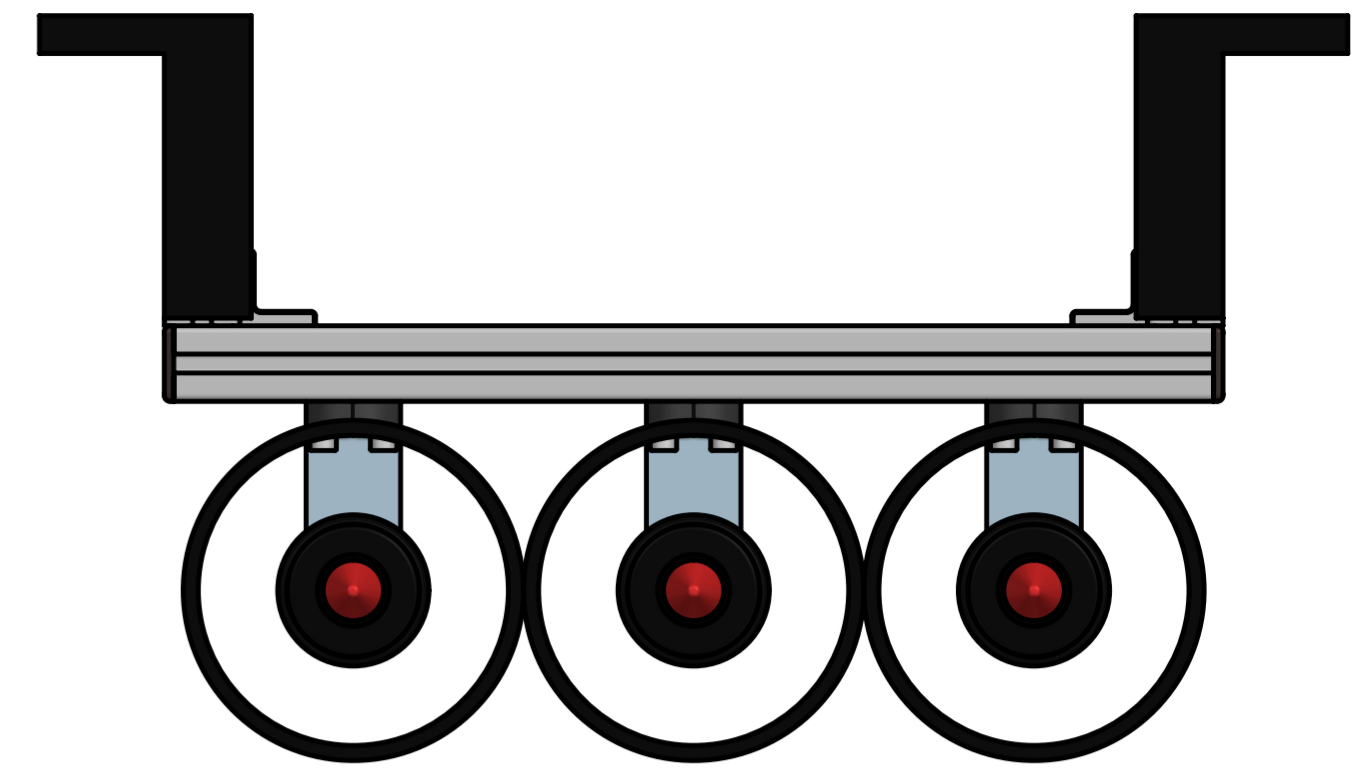
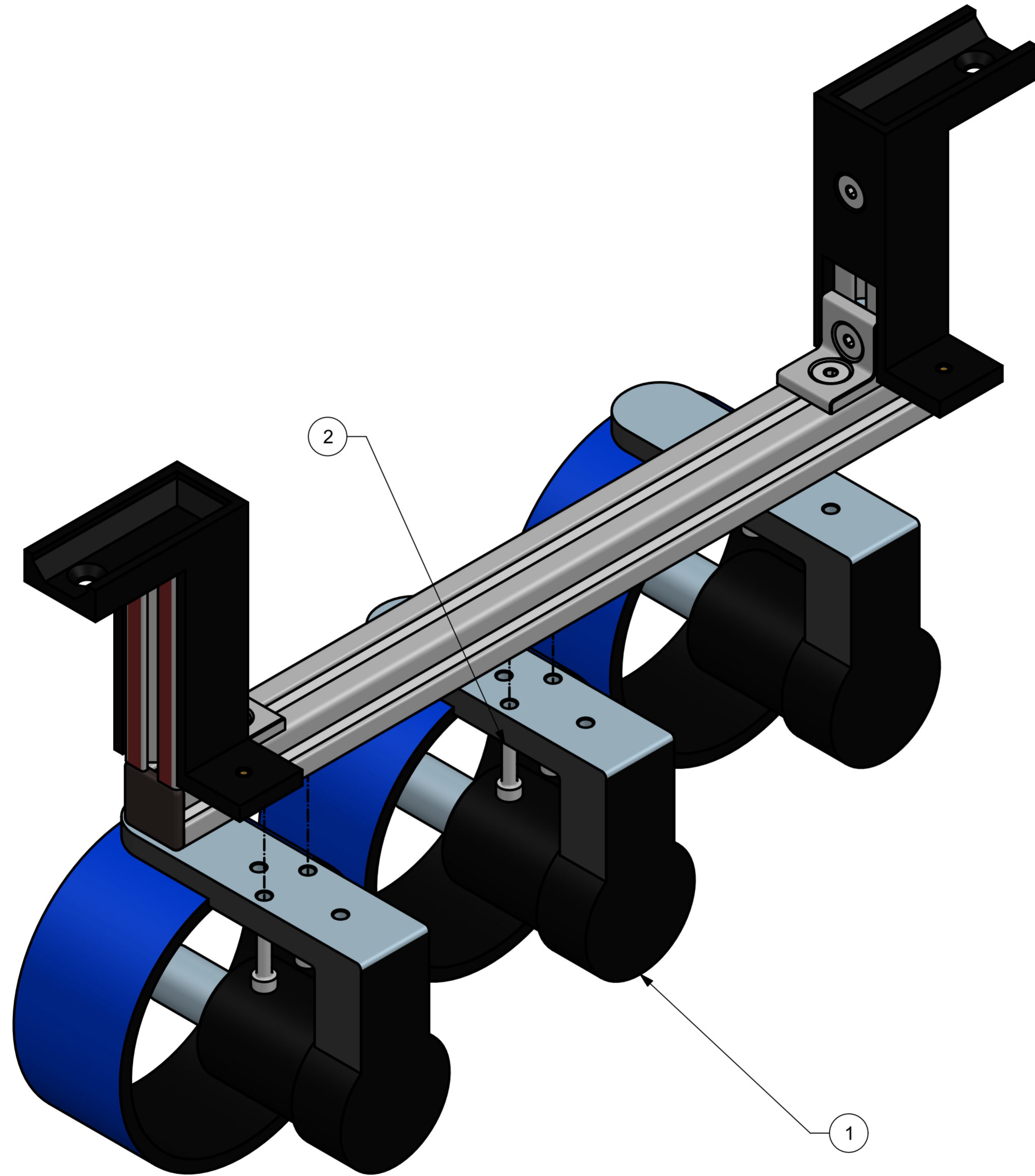

Ensure the motors are centered and evenly distributed

2	BN610-1111353 M4X14 SCREW HEX SOCKET	6
1	APISQUEEN U5 FRESHWATER THRUSTER	3
PC NO	PART NAME	QTY

Connect the M4 screws to the profile nuts inserted a few steps ago