

13	CWC-SP0008-P01_CAMSUPPORT SHORT	2
12	CWC-ST1001-A99_ITEM RIGHT ANGLE	2
11	WINKEL PROFIL 5 ITEM 0.0.677.77	2
10	ABDECKKAPPE PROFIL 5 ITEM 0.0.370.09	8
9	CWC-ST1005-P04_ITEM FRAME OUTSIDE HEIGHT	4
8	AUTOMATIK VERBINDUNGSSATZ PROFIL 5 ITEM 0.0.437.46	8
7	CWC-ST1003-P04_ITEM FRAME OUTSIDE LENGTH	4
6	CWC-ST1004-P04_ITEM FRAME OUTSIDE WIDTH	4
5	CWC-SP0011-P01_CORNERCLIP FEMALE	16
4	CWC-SP0010-P01_CORNERCLIP MALE	16
3	NUTSTEIN M5 PROFIL 5 ITEM 0.0.425.11	42
2	BN616-1208187 M5X8 SCREW HEX COUNTERSUNK	42
1	CWC-ST0003-P01_FISHTANK	1
PC NO	PART NAME	QTY

Required Tools:
- Rubber Mallet
- Measurement Tools
- Allen key set

16x

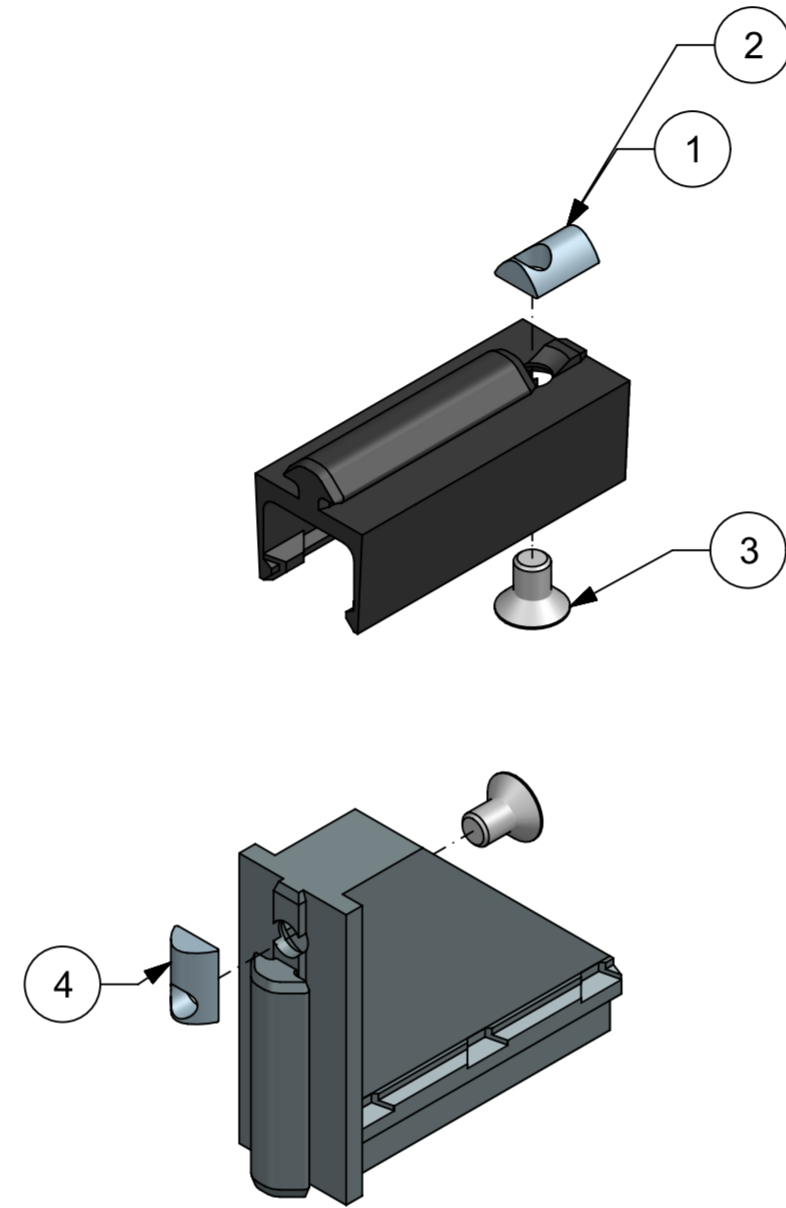

4	CWC-SP0010-P01_CORNERCLIP MALE	1
3	BN616-1208187 M5X8 SCREW HEX COUNTERSUNK	2
2	NUTSTEIN M5 PROFIL 5 ITEM 0.0.425.11	2
1	CWC-SP0011-P01_CORNERCLIP FEMALE	1
PC NO	PART NAME	QTY

2x

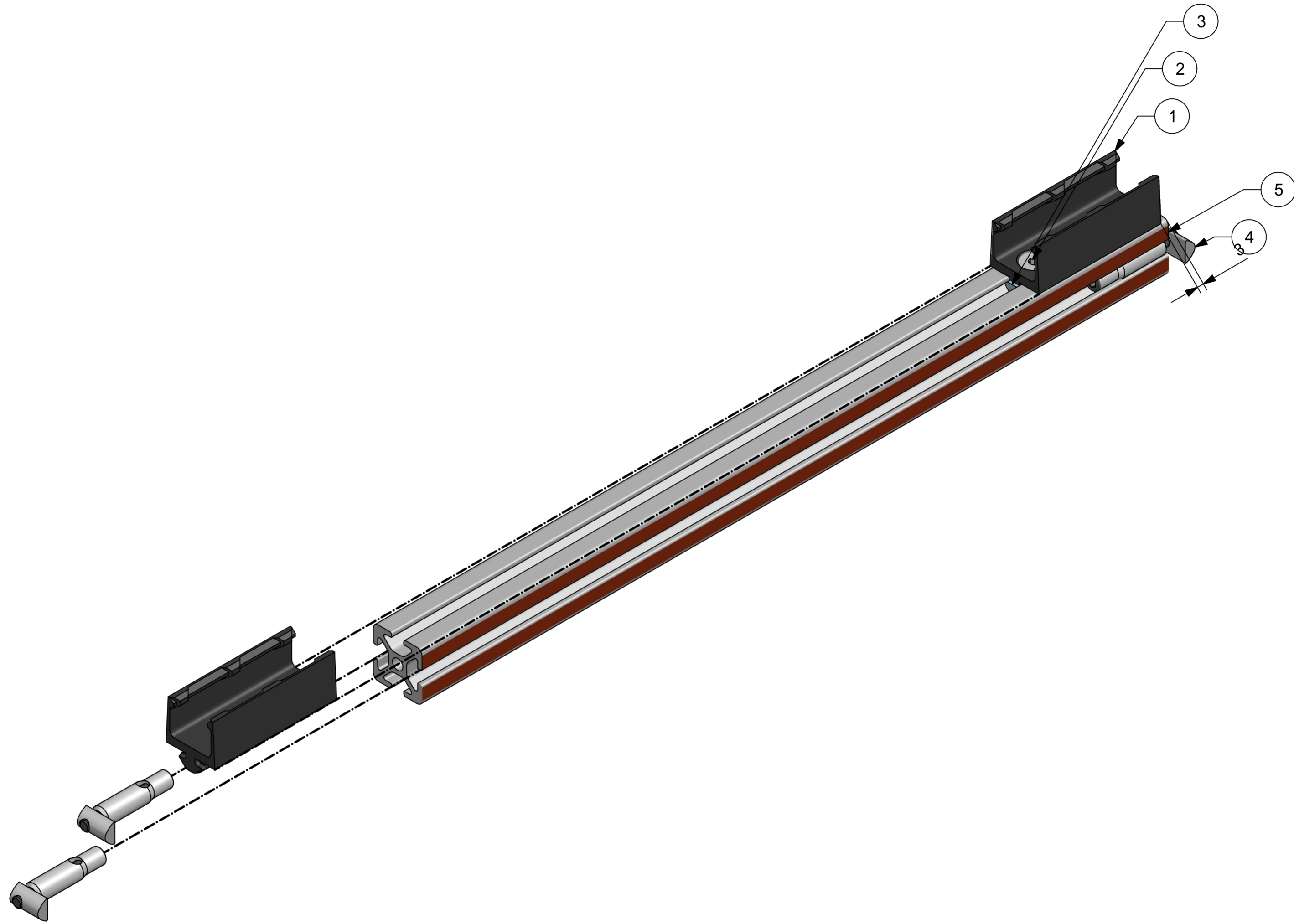

PC NO	PART NAME	QTY
5	CWC-ST1004-P04_ITEM FRAME OUTSIDE WIDTH	1
4	AUTOMATIK VERBINDUNGSSATZ PROFIL 5 ITEM 0.0.437.46	4
3	NUTSTEIN M5 PROFIL 5 ITEM 0.0.425.11	2
2	BN616-1208187 M5X8 SCREW HEX COUNTERSUNK	2
1	CWC-SP0011-P01_CORNERCLIP FEMALE	2

1. Thread-in automatic fastening joints.
2. Slide in Female CornerClip
2. a) Rubber mallet might be necessary
2. b) Note the 3 mm spacing
3. Apply PVC Tape to red surfaces.

2x

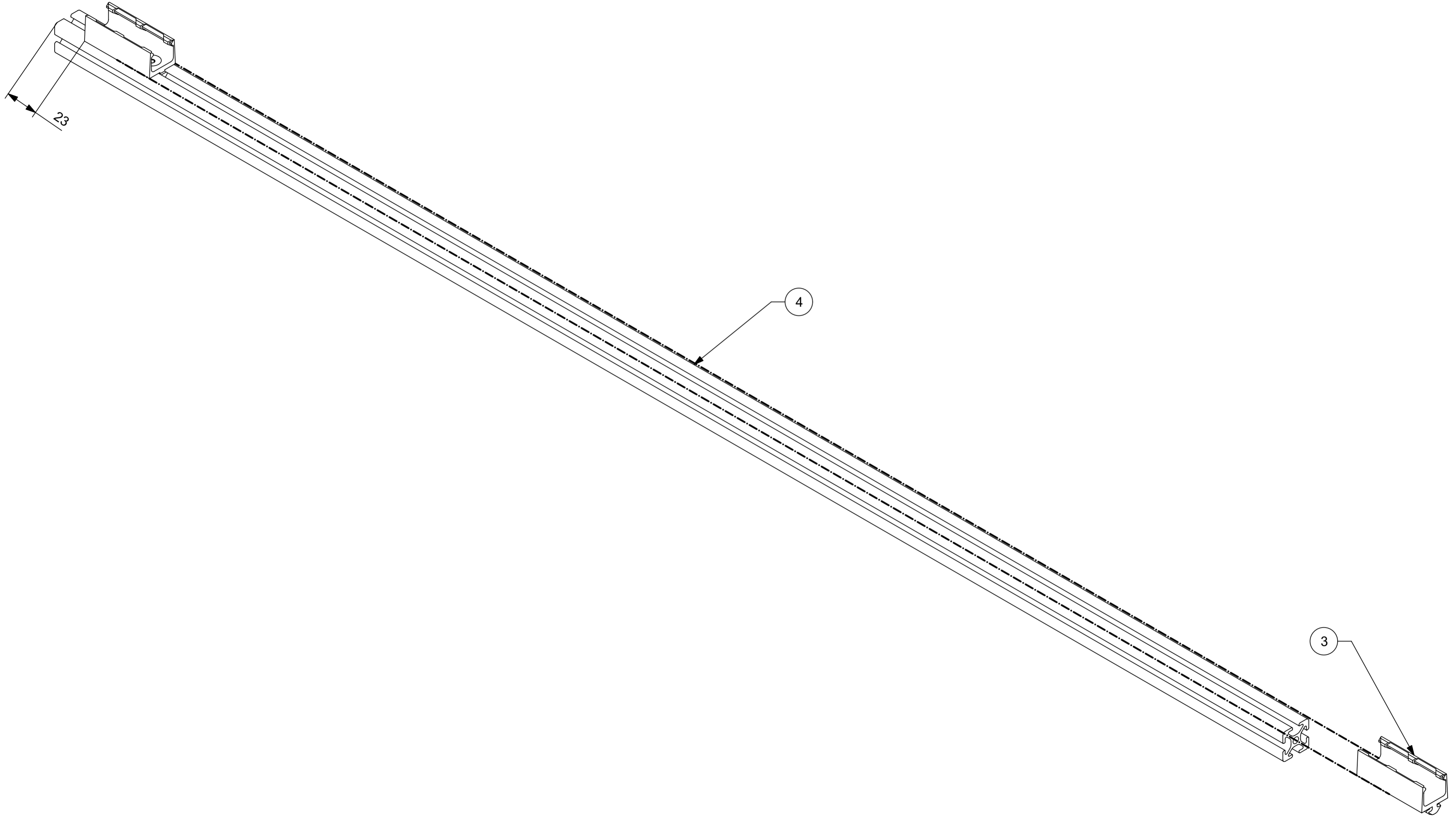

7	CWC-SP0008-P01_CAMSUPPORT SHORT	2
6	WINKEL PROFIL 5 ITEM 0.0.677.77	2
5	CWC-ST1001-A99_ITEM RIGHT ANGLE	2
4	CWC-ST1003-P04_ITEM FRAME OUTSIDE LENGTH	1
3	CWC-SP0011-P01_CORNERCLIP FEMALE	2
2	BN616-1208187 M5X8 SCREW HEX COUNTERSUNK	12

- 1. Slide in Female CornerClip
- 1. a) Rubber mallet might be necessary
- 1. b) Note the 23 mm spacing
- 2. Apply PVC Tape to red surfaces
- (!) EXCEPT (!) the leading/trailing 20 mm



1. Make sure all surfaces are flush

4x

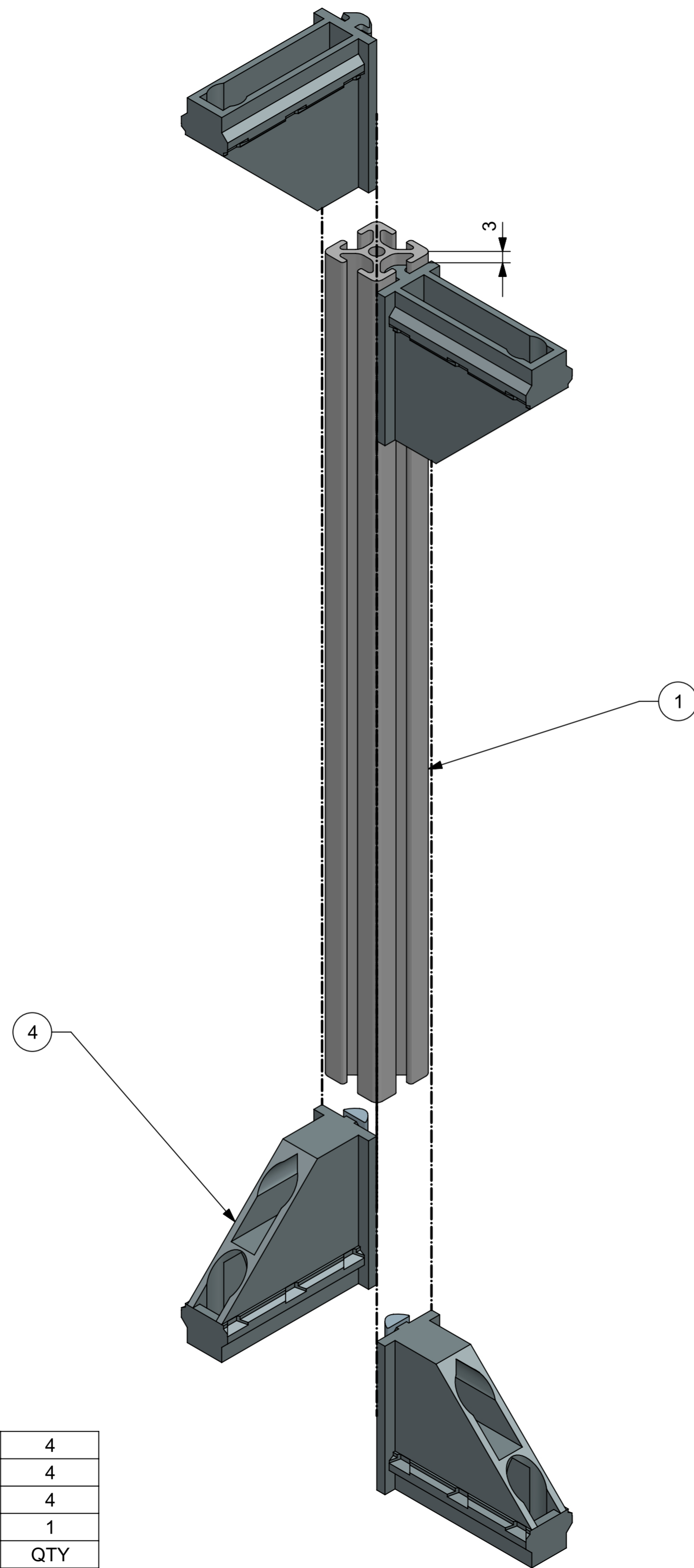

PC NO	PART NAME	QTY
4	CWC-SP0010-P01_CORNERCLIP MALE	4
3	NUTSTEIN M5 PROFIL 5 ITEM 0.0.425.11	4
2	BN616-1208187 M5X8 SCREW HEX COUNTERSUNK	4
1	CWC-ST1005-P04_ITEM FRAME OUTSIDE HEIGHT	1

- 1. Slide in Male CornerClips
- 1. a) Rubber mallet might be necessary
- 1. b) Note the 3 mm spacing
- 2. NO PVC Tape necessary

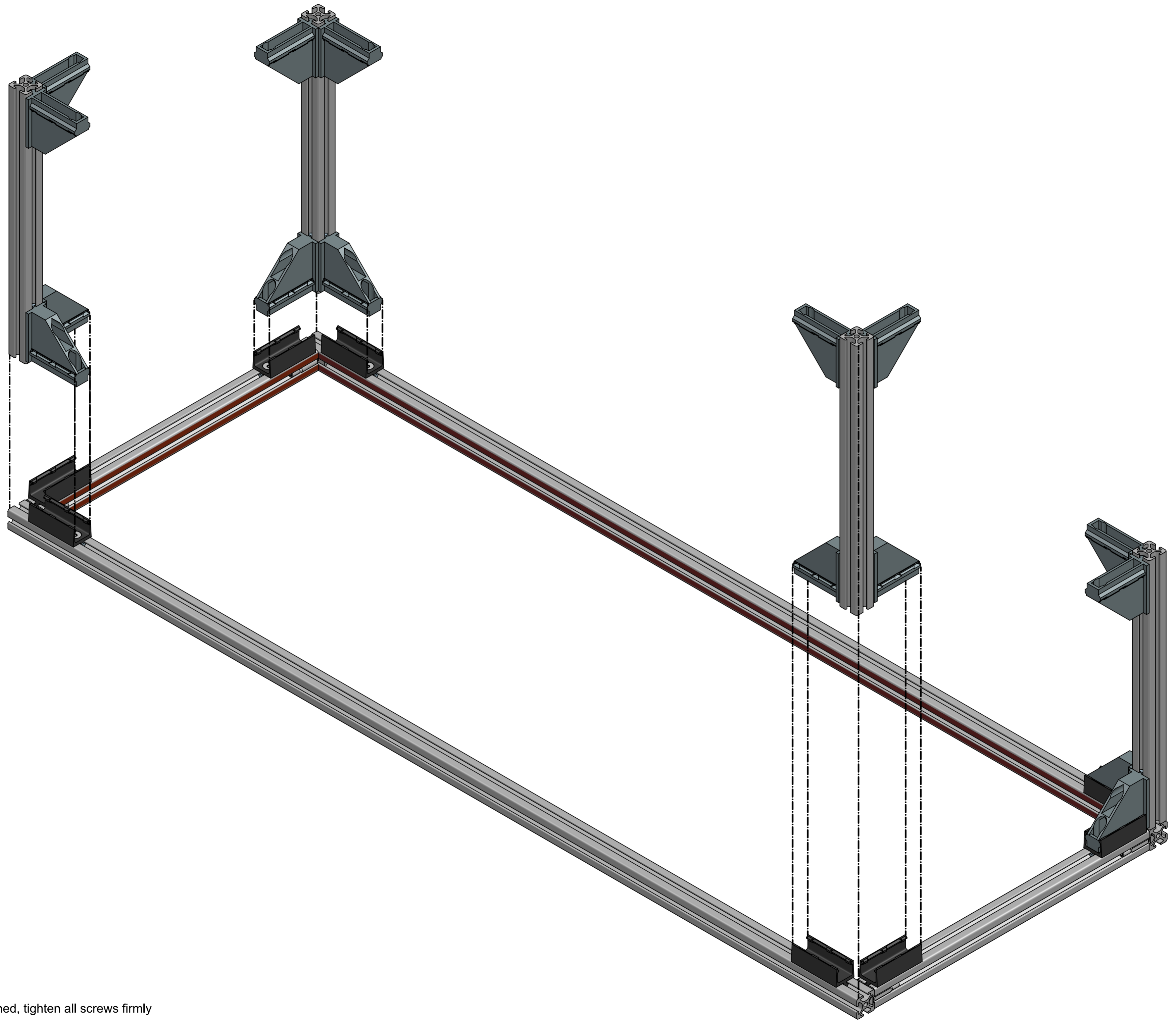

1. Once components are positioned, tighten all screws firmly
2. Rubber mallet might be necessary

2x

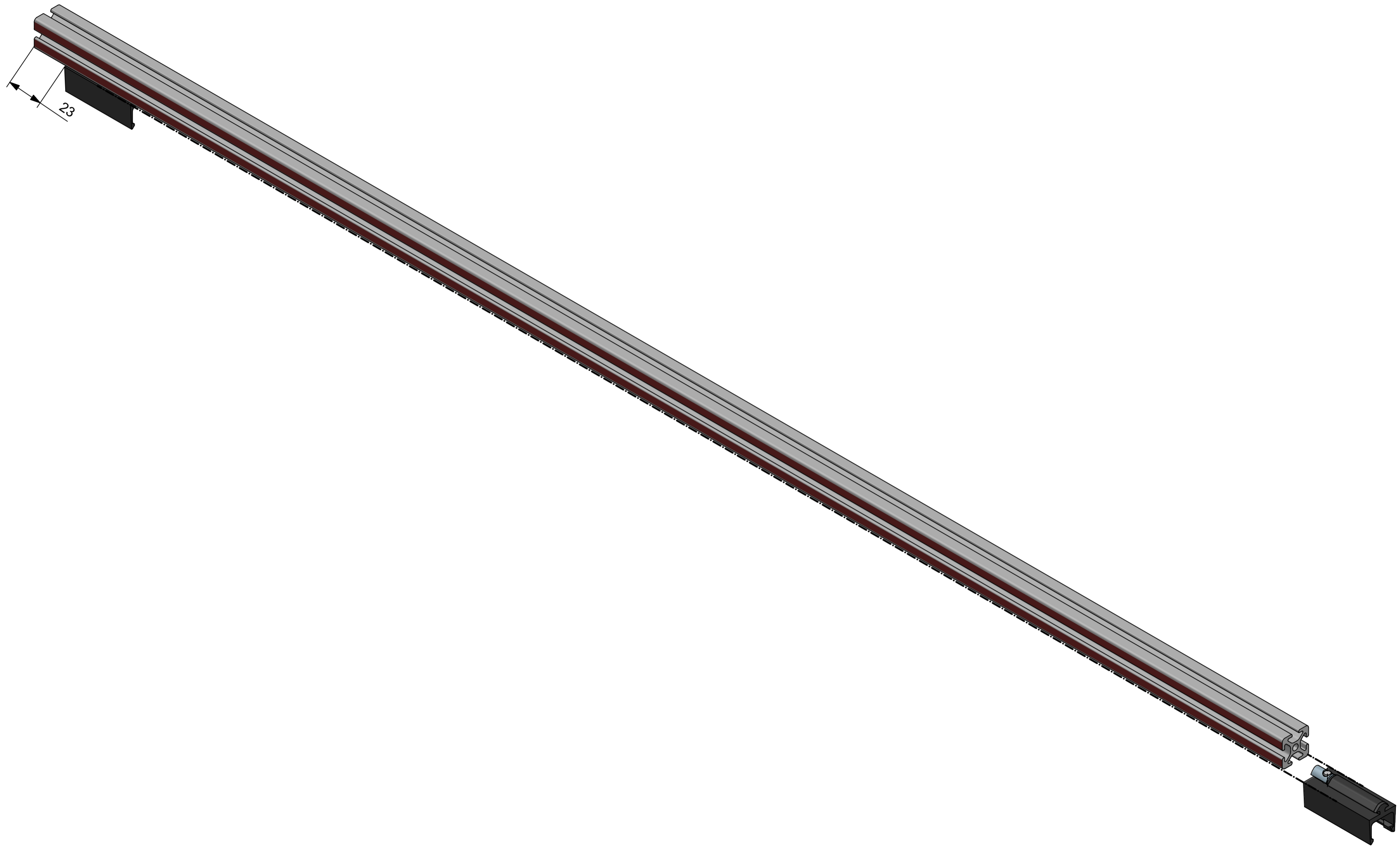

7	CWC-SP0008-P01_CAMSUPPORT SHORT	2
6	WINKEL PROFIL 5 ITEM 0.0.677.77	2
5	CWC-ST1001-A99_ITEM RIGHT ANGLE	2
4	CWC-ST1003-P04_ITEM FRAME OUTSIDE LENGTH	1
3	BN616-1208187 M5X8 SCREW HEX COUNTERSUNK	12
2	NUTSTEIN M5 PROFIL 5 ITEM 0.0.425.11	12

1. Slide in Female CornerClip
1. a) Rubber mallet might be necessary
1. b) Note the 23 mm spacing
2. Apply PVC Tape to red surfaces
- (!) EXCEPT (!) the leading/trailing 20 mm

2x

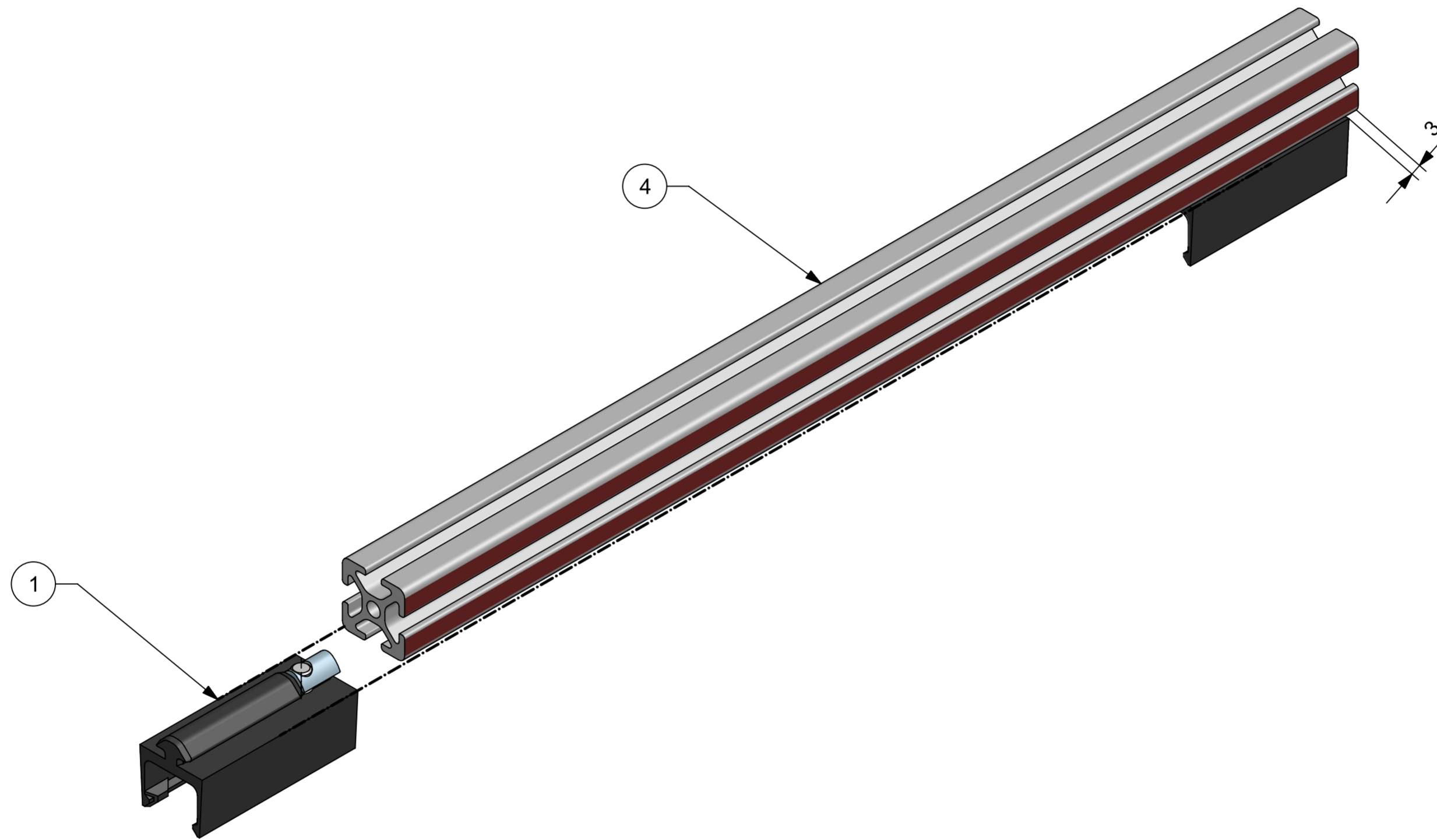

PC NO	PART NAME	QTY
4	CWC-ST1004-P04_ITEM FRAME OUTSIDE WIDTH	1
3	NUTSTEIN M5 PROFIL 5 ITEM 0.0.425.11	2
2	BN616-1208187 M5X8 SCREW HEX COUNTERSUNK	2
1	CWC-SP0011-P01_CORNERCLIP FEMALE	2

- 1. Slide in Female CornerClip
- 1. a) Rubber mallet might be necessary
- 1. b) Note the 3 mm spacing
- 2. Apply PVC Tape to red surfaces

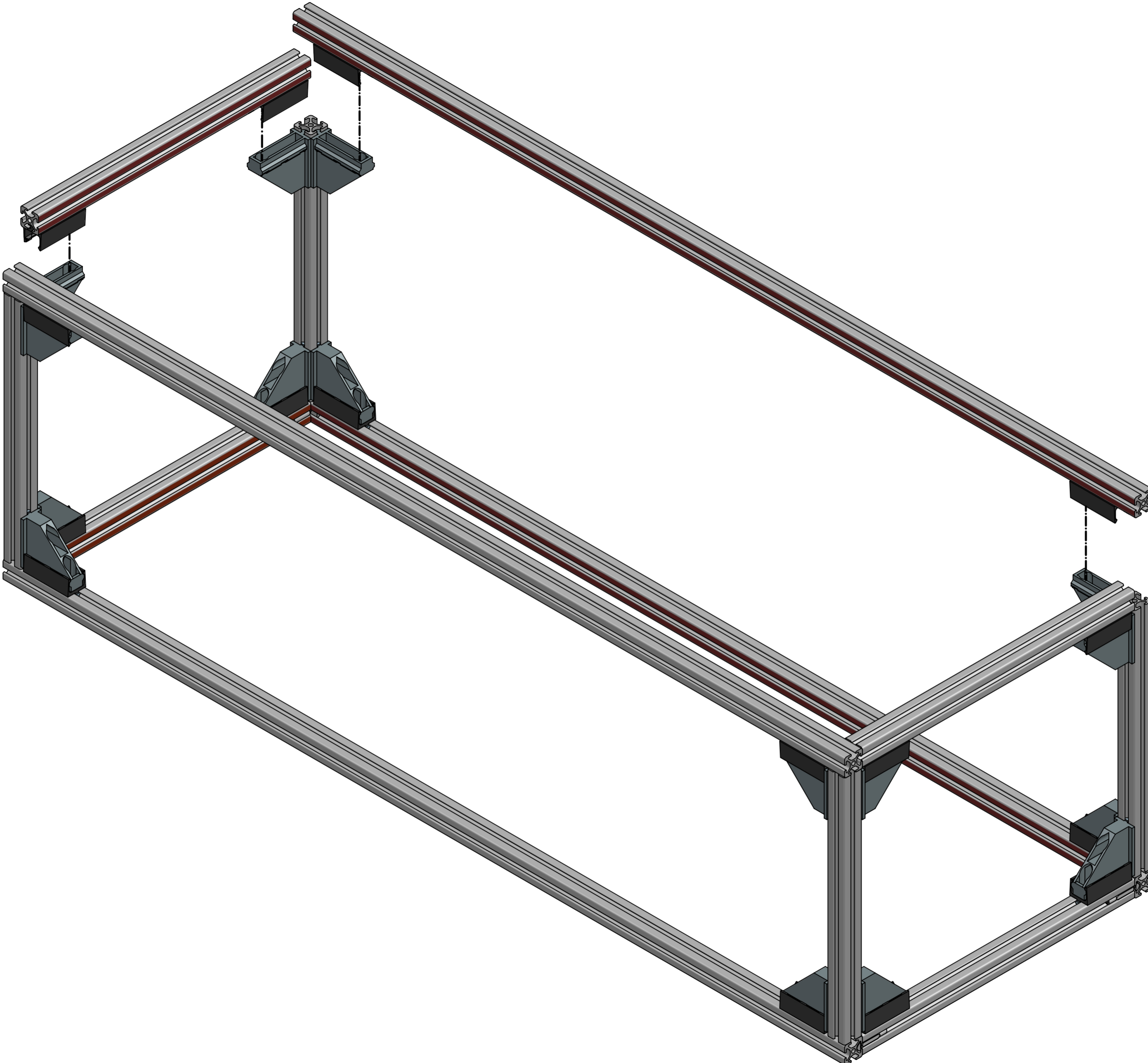

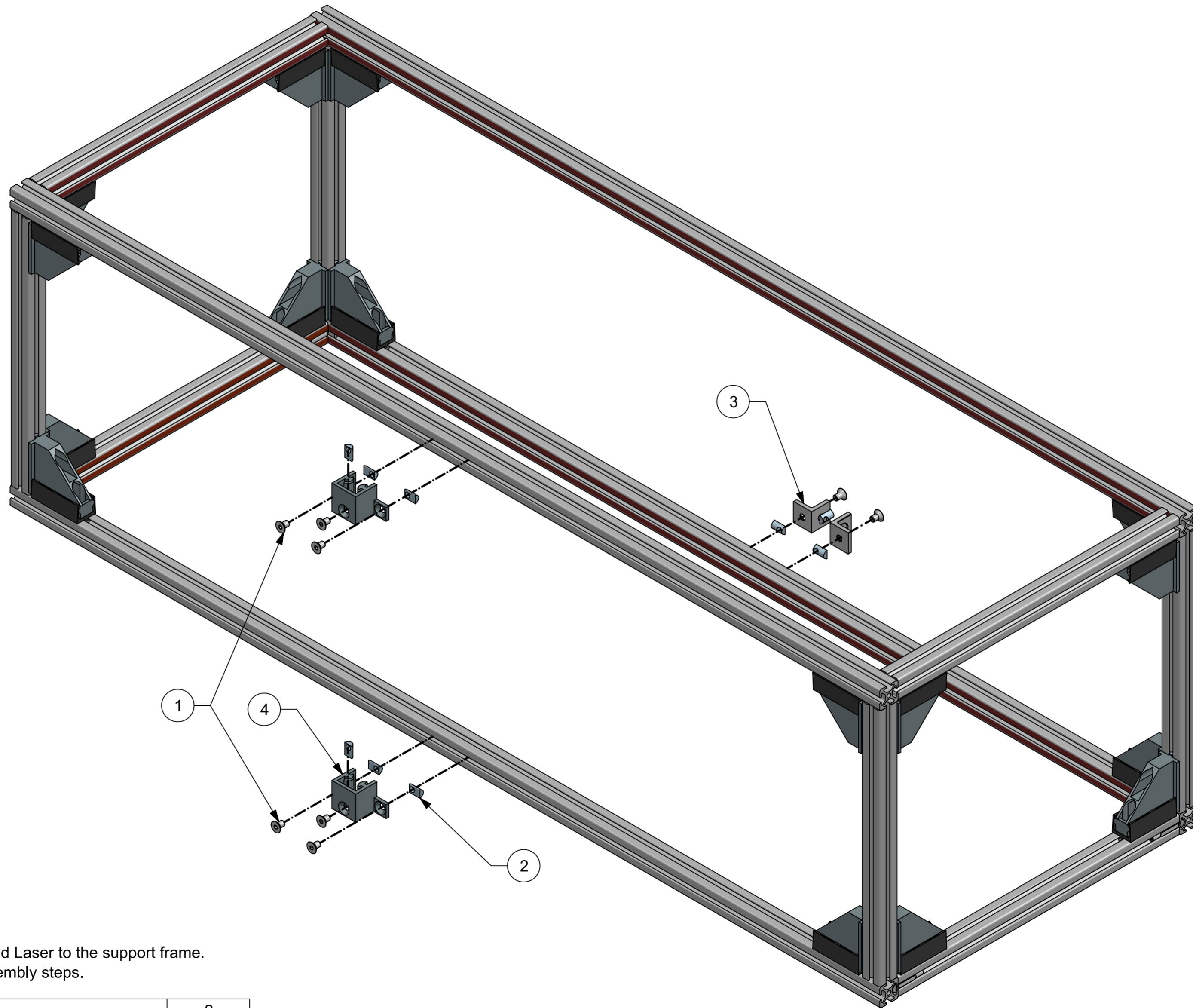

These components are used to fix the PIV Camera and Laser to the support frame.
 Their precise position can be defined during later assembly steps.

4	CWC-SP0008-P01_CAMSUPPORT SHORT	2
3	WINKEL PROFIL 5 ITEM 0.0.677.77	2
2	NUTSTEIN M5 PROFIL 5 ITEM 0.0.425.11	10
1	BN616-1208187 M5X8 SCREW HEX COUNTERSUNK	10
PC NO	PART NAME	QTY

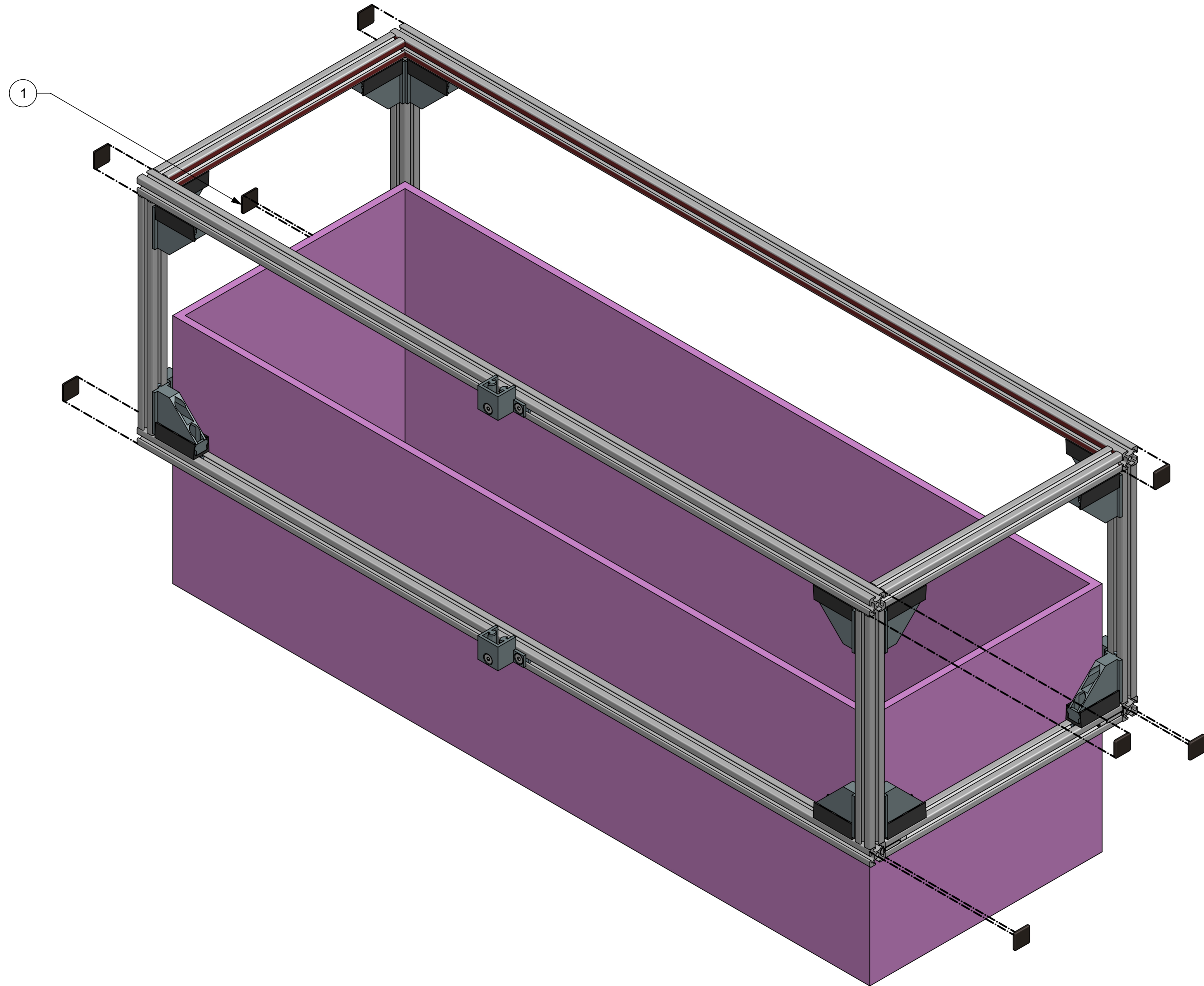

1	ABDECKKAPPE PROFIL 5 ITEM 0.0.370.09	8
PC NO	PART NAME	QTY